

## Français

### Manuel d'utilisateur

1. Connectez le dongle au projecteur
2. Allumez le projecteur et sélectionnez une source USB
3. Téléchargez et installez l'application adéquate pour votre projecteur

**Note:** *Rendez-vous sur notre site internet pour connaître l'application adéquate et la liste des fonctionnalités prises en charge*

4. Connectez le SSID sans fil. "NetworkDisplay", "Optoma Display", "HDCastPro\_xxxxxxx"
5. Ouvrez l'application
6. Commencez à présenter

## Deutsche

### Bedienungsanleitung:

1. Stecken Sie den USB Dongle in einen freien USB-Port Ihres Projektors
2. Schalten Sie Ihren Projektor an und wählen Sie den entsprechenden USB Eingang
3. Laden Sie die entsprechende APP für Ihren Projektor herunter und installieren Sie die APP

**Achtung:** *Eine Liste mit unterstützenden Features und welche APP genau Ihren Projektor unterstützt, finden Sie über unsere Webseite!*

4. Stellen Sie die Verbindung mit Ihrem Netzwerk her Netzwerk-Display, Optoma-Display, HDCastPro\_ xxxxxxx
5. Öffnen Sie die APP
6. Starten Sie die Präsentation

## Español

### Manual de usuario básico

1. Conecte el dongle al proyector
2. Encienda el proyector y selecciona la fuente USB
3. Descargue e instale la aplicación pertinente para el proyector

**Nota:** *Por favor, visite nuestro sitio web para la aplicación correcta y una lista de las funciones compatibles*

4. Conectar a SSID inalámbrico. " NetworkDisplay " "Pantalla Optoma " , " HDCastPro\_ xxxxxxx " "
5. Abra la aplicación
6. Inicie la presentación

## Italiano

### Manuale base

1. Collegare il dongle al proiettore
2. Accendere il proiettore e selezionare la sorgente USB
3. Scaricare e installare l'applicazione per il proiettore

**Nota:** *Si prega di visitare il nostro sito web per l'applicazione corretta e l'elenco delle funzioni supportate*

4. Connessione a wireless SSID "NetworkDisplay", "Optoma Display", "HDCastPro\_ xxxxxxx"
5. Aprire l'applicazione
6. Avviare la presentazione

## Copyright

© Copyright 2015. This publication, including all photographs, illustrations and software, is protected under international copyright laws, with all rights reserved. Neither this manual, nor any of the material contained herein, may be reproduced without written consent of the author.

## Disclaimer

The information in this document is subject to change without notice. The manufacturer makes no representations or warranties with respect to the contents hereof and specifically disclaims any implied warranties of merchantability or fitness for any particular purpose. The manufacturer reserves the right to revise this publication and to make changes from time to time in the content hereof without obligation of the manufacturer to notify any person of such revision or changes.

## Trademarks

Optoma and its logo is a registered trademark of Optoma Corporation. Optoma Europe Ltd is the licensee of the registered trademark. Android is a registered trademark of Google Inc. Windows is a registered trademark of Microsoft Corporation in the United States and/or other countries. OS X is registered trademarks of Apple Inc. iOS is a trademark or registered trademark of Cisco in the U.S. and other countries and is used under license.

## Declaration of conformity

EMC Directive 2004/108/EC (including amendments).  
Low Voltage Directive 2006/95/EC.  
R & TTE Directive 1999/5/EC (if product has RF function)



## Disposal instructions

Do not throw this electronic device into the trash when discarding. To minimize pollution and ensure utmost protection of the global environment, please recycle it

[www.optoma.com](http://www.optoma.com)



# WUSB



## Basic user manual



[www.optoma.com](http://www.optoma.com)

1 Connect dongle to projector



2 Turn on projector and select USB source

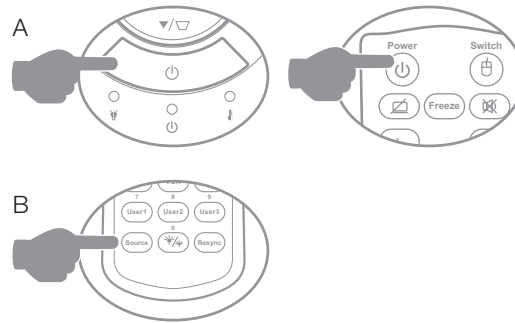

3 Download and install the relevant app for your projector

iOS/Android devices

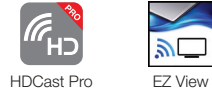

Mac/PC devices



**Note:** Please visit our website for the correct app and a list of supported features

4 Connect to wireless SSID

“NetworkDisplay”  
“Optoma Display”  
“HDCastPro\_xxxxxxxx”

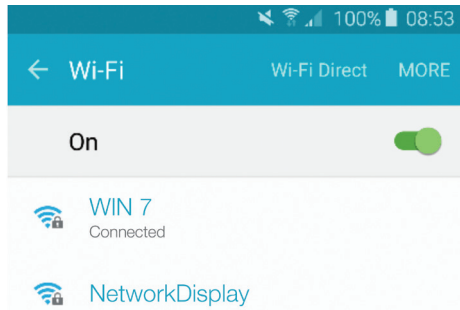

5 Open the app

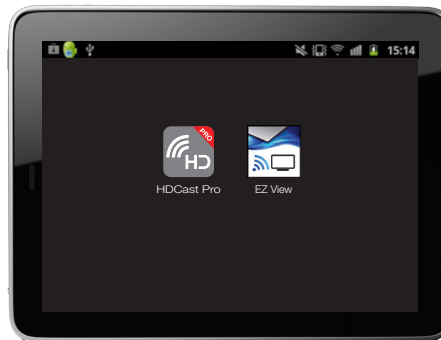

6 Start presenting

